

SIP SERIES

HD101

SIP Cordless 1-line Hotel Telephone

HD101W

SIP Cordless 1-line Wi-Fi Enabled Hotel Telephone

HD1

SIP Cordless 1-line Handset and Charger

snom

User Manual

IMPORTANT SAFETY INSTRUCTIONS

The applied nameplate is located at the bottom or rear of the product.

When using your telephone equipment, basic safety precautions should always be followed to reduce the risk of fire, electric shock and injury, including the following:

1. This product should be installed by a qualified technician. power company.
2. This product should only be connected to the host equipment and never directly to the network such as Public Switch Telephone Network (PSTN) or Plain Old Telephone Services (POTS).
3. Read and understand all instructions.
4. Follow all warnings and instructions marked on the product.
5. Unplug this product from the wall outlet before cleaning. Do not use liquid or aerosol cleaners. Use a damp cloth for cleaning.
6. Do not use this product near water such as near a bath tub, wash bowl, kitchen sink, laundry tub or swimming pool, or in a wet basement or shower.
7. Do not place this product on an unstable table, shelf, stand or other unstable surfaces.
8. Slots and openings in the back or bottom of the telephone base and handset are provided for ventilation. To protect them from overheating, these openings must not be blocked by placing the product on a soft surface such as a bed, sofa or rug. This product should never be placed near or over a radiator or heat register. This product should not be placed in any area where proper ventilation is not provided.
9. This product should be operated only from the type of power source indicated on the marking label. If you are not sure of the type of power supply on the premises, consult your dealer or local
10. Do not allow anything to rest on the power cord. Do not install this product where the cord may be walked on.
11. Never push objects of any kind into this product through the slots in the telephone base or handset because they may touch dangerous voltage points or create a short circuit. Never spill liquid of any kind on the product.
12. To reduce the risk of electric shock, do not disassemble this product, but take it to an authorized service facility. Opening or removing parts of the telephone base or handset other than specified access doors may expose you to dangerous voltages or other risks. Incorrect reassembling can cause electric shock when the product is subsequently used.
13. Do not overload wall outlets and extension cords.
14. Unplug this product from the wall outlet and refer servicing to an authorized service facility under the following conditions:
 - When the power supply cord or plug is damaged or frayed.
 - If liquid has been spilled onto the product.
 - If the product has been exposed to rain or water.
 - If the product does not operate normally by following the operating instructions. Adjust only those controls that are covered by the operation instructions. Improper adjustment of other controls may

result in damage and often requires extensive work by an authorized technician to restore the product to normal operation.

- If the product has been dropped and the telephone base and/or handset has been damaged.
 - If the product exhibits a distinct change in performance.
15. Avoid using a telephone (other than cordless) during an electrical storm. There is a remote risk of electric shock from lightning.
16. Do not use the telephone to report a gas leak in the vicinity of the leak. Under certain circumstances, a spark may be created when the adapter is plugged into the power outlet, or when the handset is replaced in its cradle. This is a common event associated with the closing of any electrical circuit. The user should not plug the phone into a power outlet, and should not put a charged handset into the cradle, if the phone is located in an environment containing concentrations of flammable or flame-supporting gases, unless there is adequate ventilation. A spark in such an environment could create a fire or explosion. Such environments might include: medical use of oxygen without adequate ventilation; industrial gases (cleaning solvents; gasoline vapours; etc.); a leak of natural gas; etc.
17. Only put the handset of your telephone next to your ear when it is in normal talk mode.
18. The power adapters are intended to be correctly oriented in a vertical or floor mount position. The prongs are not designed to hold the plug in place if it is plugged into a ceiling, under-the-table or cabinet outlet.

19. Use only the power cord and batteries indicated in this manual. Do not dispose of batteries in a fire. They may explode. Check with local codes for possible special disposal instructions.
20. In wall mounting position, make sure to mount the telephone base on the wall by aligning the eyelets with the mounting studs of the wall plate. Then slide the telephone base down on both mounting studs until it locks into place. Refer to the full instructions in Installation in the user's manual.
21. This product should be mounted at a height of less than 2 meters.
22. Listed PoE (The product is considered not likely to require connection to an Ethernet network with outside plant routing).

   CAUTIONS

- Keep small metallic objects such as pins and staples away from the handset receiver.
- There may be a risk of explosion if a wrong type of handset battery is used (HD101, HD101W and HD1). Use only the supplied rechargeable battery (Ni-MH AAA 550mAh 2.4V) or replacement battery. Dispose of used batteries according to the instructions.





SAVE THESE INSTRUCTIONS

TABLE OF CONTENTS

Important safety instructions.....	2
Parts check list.....	5
Layout	7
Installation.....	8
Set up	14
Voice Menu	15
Operation.....	16
Appendix	18
Troubleshooting.....	18
Maintenance	24
Disclaimer and Limitation of Liability	24
European Directives	24
Declaration of Conformity	24
Disposal of batteries and product.....	25

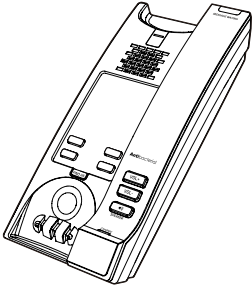

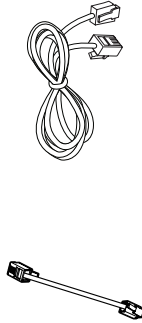
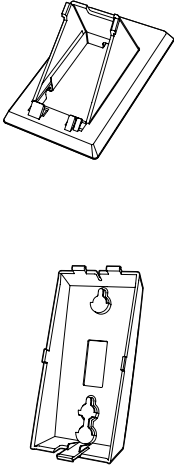
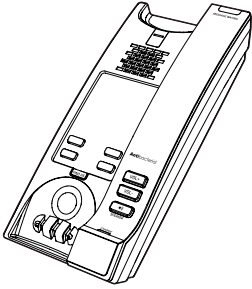
Parts check list

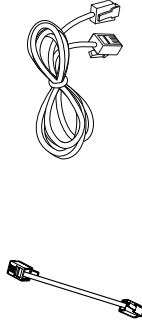
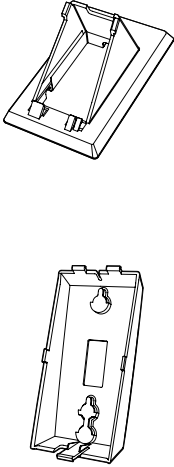
Items contained in the respective **cordless telephone** package:

MODEL NAME	MODEL NUMBER	PARTS INCLUDED			
		TELEPHONE BASE WITH FACEPLATE AND OVERLAY CHARGING STAND	CORDLESS HANDSET AND HANDSET BATTERY	NETWORK CABLE ADAPTER	BASE STAND WALL MOUNT BRACKET
SIP Cordless 1-line Hotel Telephone	HD101				
SIP Cordless 1-line Wi-Fi Enabled Hotel Telephone	HD101W				

Parts check list

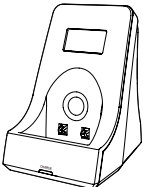
Items contained in the respective **cordless telephone** package:

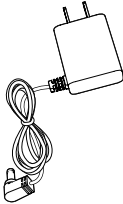
MODEL NAME	MODEL NUMBER	PARTS INCLUDED			
		TELEPHONE BASE WITH FACEPLATE AND OVERLAY CHARGING STAND	CORDLESS HANDSET AND HANDSET BATTERY	NETWORK CABLE ADAPTER	BASE STAND WALL MOUNT BRACKET
SIP Cordless 1-line Handset and Charger	HD1				

Layout

SIP Cordless 1-line Hotel Telephone - HD101

SIP Cordless 1-line Wi-Fi Enabled Hotel Telephone - HD101W

SIP Cordless 1-line Handset - HD1 Handset

TELEPHONE BASE

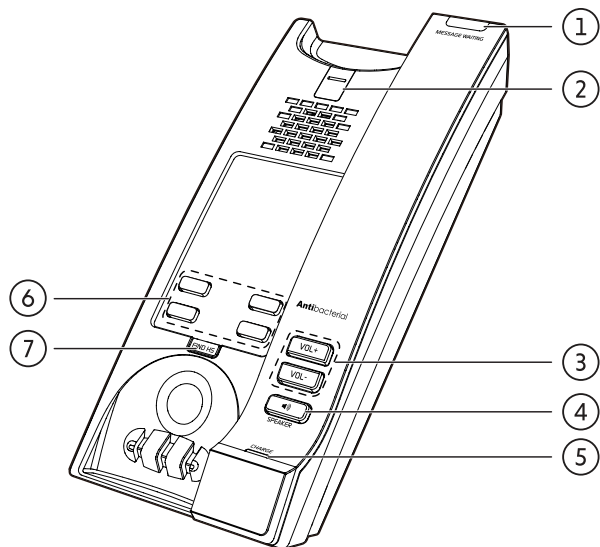

1	MESSAGE WAITING LED
2	Wall mount clip
3	VOLUME +/-
4	▶/SPEAKER
5	CHARGE LED
6	Speed dial keys
7	FIND HS (FIND HANDSET)

HANDSET

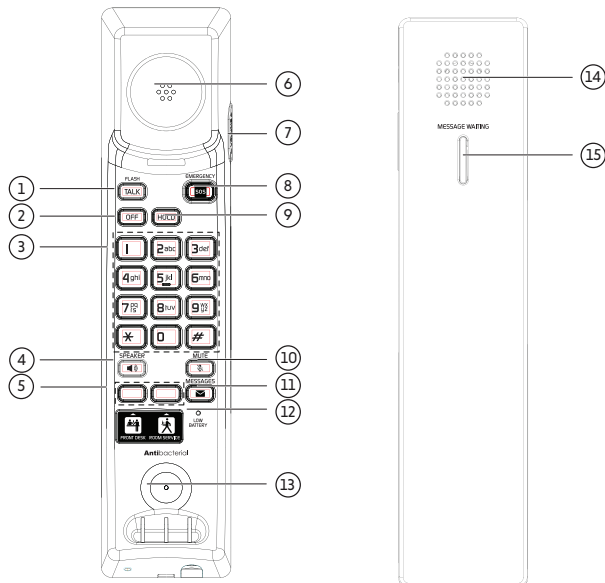

1	FLASH/TALK
2	OFF
3	Numeric dial keys
4	▶/SPEAKER
5	Speed dial keys
	Programmable key #1
	Programmable key #2
6	Handset earpiece
7	VOLUME +/-
8	SOS/EMERGENCY
9	HOLD
10	🔇/MUTE
11	✉/MESSAGES
12	Low Battery LED
13	Microphone
14	Speakerphone
15	MESSAGE WAITING LED

Charger - HD1 Charger

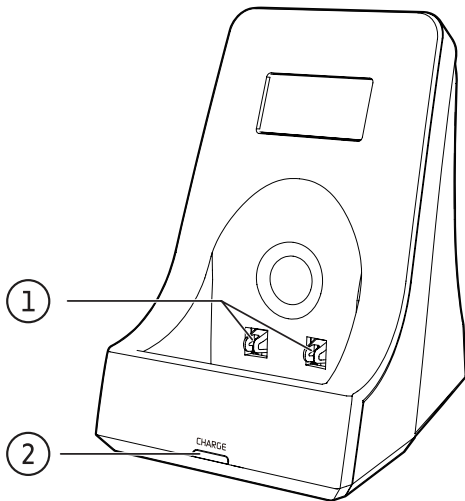

1	Charging poles
2	CHARGE LED

Installation

SIP Cordless 1-line Hotel Telephone - HD101

SIP Cordless 1-line Wi-Fi Enabled Hotel Telephone - HD101W

INSTALLATION OPTION - INSTALL BASE STAND FOR DESKTOP

TO MOUNT THE BASE STAND

1. Align the grooves with the base stand.
2. Slide down to secure the stand.

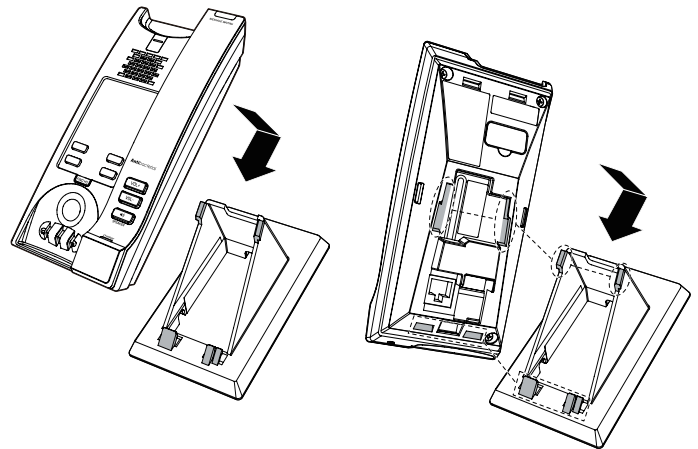

TO UNMOUNT THE BASE STAND

Simply slide up and lift the telephone base from the base stand.

TELEPHONE BASE INSTALLATION

The telephone comes ready for desktop use.

1. Install the telephone base as shown below.

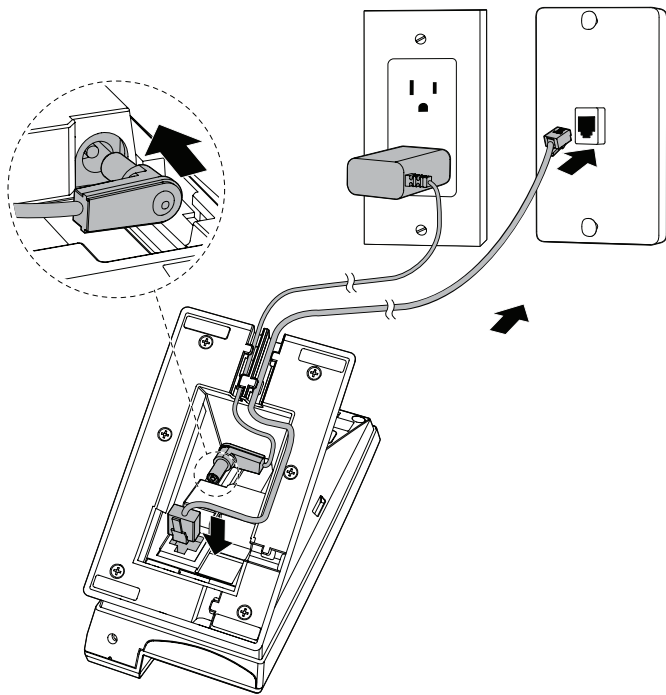

2. When the telephone base has been initially installed, make sure the power adapter is securely plugged into an outlet not controlled by a wall switch, and the network cable is plugged into the network wall jack.
3. Bend a small paper clip and gently insert it to the Handset battery ON pinhole to turn on the handset.

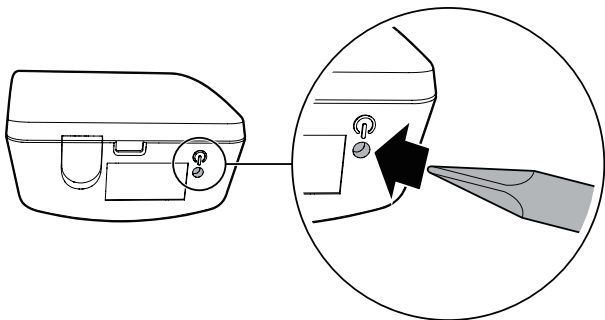

- Without turning on the battery, the handset cannot be charged or operate.
- The battery is fully charged after 16 hours of continuous charging. For best performance, keep the cordless handset in the telephone base when not in use.

4. Press **▲/SPEAKER** on the telephone base. Listen for a dial tone, and then press **▲/SPEAKER** again to hang up.

NOTE

- The dial tone will not be played if the SIP account used by this phone cannot be registered.
- The adapter sold separately.

CAUTIONS

Use only the supplied cable and specified power adapter. The supplied cable is not designed for use in any other IT devices. Misusing it on your other IT devices shall be prohibited. To order a replacement, contact authorized service personnel, your seller, or Snom.

INSTALLATION OPTION - CONVERTING FROM DESKTOP TO WALL MOUNT POSITION

TO MOUNT THE TELEPHONE BASE ON THE WALL

1. Unmount the base stand. Put the cordless handset aside. On the telephone base, press the wall mount clip upward and rotate a half turn (180°). Slide back the clip.
 - It locks into place with the protruding edge pointing towards the upper edge of the telephone base. This protruding edge holds the cordless handset when the phone is mounted on the wall.

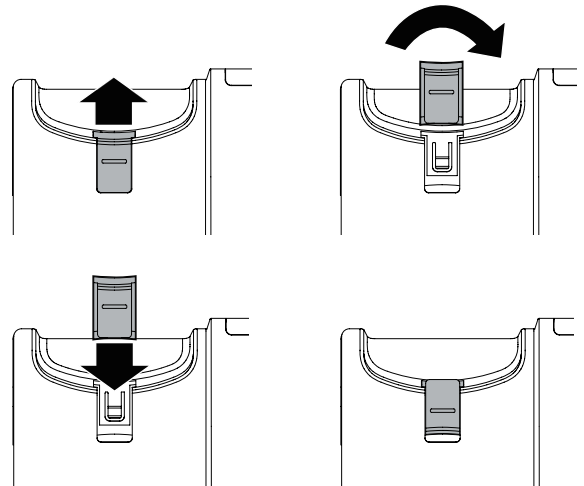

2. Install the telephone base as shown.

NOTE

- The adapter is sold separately.

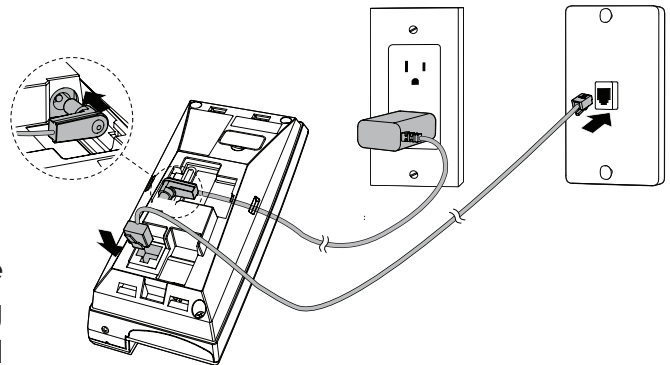

3. Turn the telephone base over with the bottom side facing up. Insert the mounting bracket into the two upper grooves and a lower groove on the telephone base until they lock securely. In the meantime, the telephone cord sticks out from the rectangular hole and affix coil handset cord by fitting it in the semi-circle holes at the bottom of the mounting bracket as shown below.

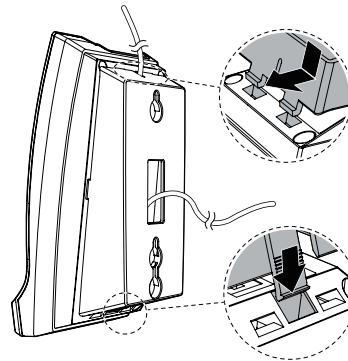

4. Mount the telephone base on the wall by positioning the eyelets on the telephone base and the mounting bracket against the mounting studs. Then slide the telephone base down on both mounting studs until it locks into place.

5. Replace the handset on the telephone base cradle.

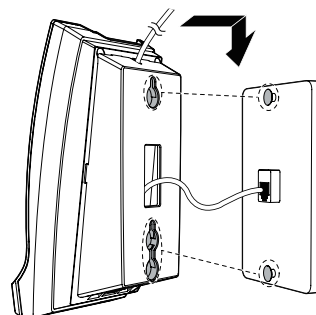

SIP Cordless 1-line Handset - HD1 Handset

HANDSET BATTERY REPLACEMENT

The handset battery is pre-installed.

To replace the handset battery, follow as shown below.

1. Use a narrow object to pry open the screw cover and remove the screw with cross head screwdriver. Then, insert a 5 mm standard flat head screwdriver in the provided slot and gently open the handset cover.

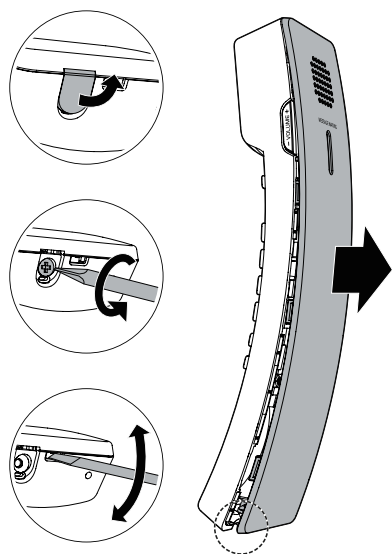

2. Unplug the battery connector from the socket and then remove the battery from the handset battery compartment.
3. Plug the battery connector securely into the socket inside the handset battery compartment. Place the battery with the label **THIS SIDE UP** facing up or the battery with the label **THIS SIDE DOWN** facing down and the wires inside the battery compartment.
4. To replace the handset cover, align all the tabs on the handset cover against the corresponding grooves on the handset, then firmly push downward until all the tabs lock in the grooves. Then install the screw.

⚠ CAUTIONS

- There may be a risk of explosion if a wrong type of handset battery is used. Use only the supplied rechargeable battery. To order a replacement, contact authorized service personnel, your seller, or Snom.
- Dispose of used batteries according to the instructions.

Charger - HD1 Charger

CHARGING STAND INSTALLATION

The telephone comes ready for desktop use.

1. Install the charger base as shown below.
 - Make sure the power adapter is securely plugged into an outlet not controlled by a wall switch.

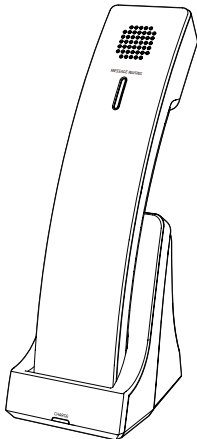
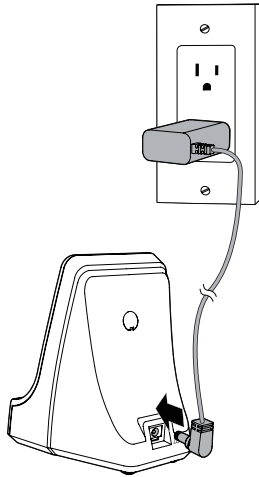

2. Bend a small paper clip and gently insert it to the Handset battery ON pinhole to turn on the handset.
 - Without turning on the battery, the handset cannot be charged or operate.
 - The battery is fully charged after 16 hours of continuous charging. For best performance, keep the cordless handset in the charging stand when not in use.
3. Press **◀/SPEAKER** on the handset. Listen for a dial tone, and then press **▶/SPEAKER** again to hang up.

⚠ CAUTIONS

Use only the supplied power adapter. The supplied power adapter is not designed for use in any other IT devices. Misusing it on your other IT devices shall be prohibited. To order a replacement, contact authorized service personnel, your seller, or Snom.

HANDSET REGISTRATION

Place the cordless handset on the telephone base cradle. Handset registration happens automatically the first time a cordless handset is placed on the telephone base.

When the registration process completes, the **MESSAGE WAITING** LED flashes once and you hear 3 rising beeps as confirmation.

Each telephone base accommodates up to 4 cordless handsets. When you already have 4 registered handsets, you can replace one of them by a new handset if any one of the 4 registered handsets is disconnected from the base. For example, it is out of range, or its battery is removed or depleted. The previous registered handset is then deregistered from the telephone base.

HANDSET DEREGISTRATION

When a registered cordless handset is idle, press ***331734#**, then press **HOLD** and ***883247#**. You hear a confirmation tone when the deregistration process completes.

REGISTER A HANDSET TO ANOTHER TELEPHONE BASE

Any contemporary cordless 1-line handset can register to any contemporary cordless 1-line telephone base. Any contemporary cordless 2-line handset can register to any contemporary cordless 2-line telephone base.

When a registered cordless handset is idle, place it on another telephone base. This cordless handset automatically registers to the new telephone base.

HANDSET BATTERY CHARGING

The battery must be fully charged before using the cordless handset for the first time. The **CHARGE** LED turns on when the cordless handset is charging on the telephone base, charging stand. The battery is fully charged after 16 hours of continuous charging. For best performance, keep the cordless handset in the telephone base, charging stand when not in use.

Set up

SIP Cordless 1-line Hotel Telephone - HD101

SIP Cordless 1-line Wi-Fi Enabled Hotel Telephone - HD101W

SIP Cordless 1-line Handset - HD1 Handset

Default settings are indicated by asterisks (*).

SETTING	OPTIONS	ADJUSTABLE BY
Listening volume- Handset	1, 2, 3, 4, 5, 6*, 7, 8	User and administrator
Speakerphone volume - Handset	1, 2, 3, 4, 5, 6*, 7, 8	User and administrator
Speakerphone volume - telephone base	1, 2, 3, 4, 5, 6*, 7, 8	User and administrator
Ringer volume - telephone base	1, 2, 3, 4, 5, 6*, 7, 8	User and administrator
Ringer tone	Tone 1*, Tone 2, Tone 3	Administrator only

All telephone settings are programmed through the administrative web portal. Please refer to the SIP Phone Configuration Guide for details.

Voice Menu

The Voice menu enables you to use the handset to query and change phone settings.

To access the Voice Menu:

1. When the phone is idle, press this key sequence on the handset: **TALK * * * ***.
A digitized voice on the handset will announce Voice Menu options.
2. Press the number key on the handset to select the desired menu option, or enter information.
A list of menu options is shown in the diagram below.
For example, to find out the IP address of the phone, press **1** for Network Configuration, then press **2** for IP Address.
3. When you are finished with the Voice menu, press **OFF** on the handset or place it in the cradle.
NOTE: if you changed any network settings, your phone will automatically reboot.
This will enable your new settings to take effect.

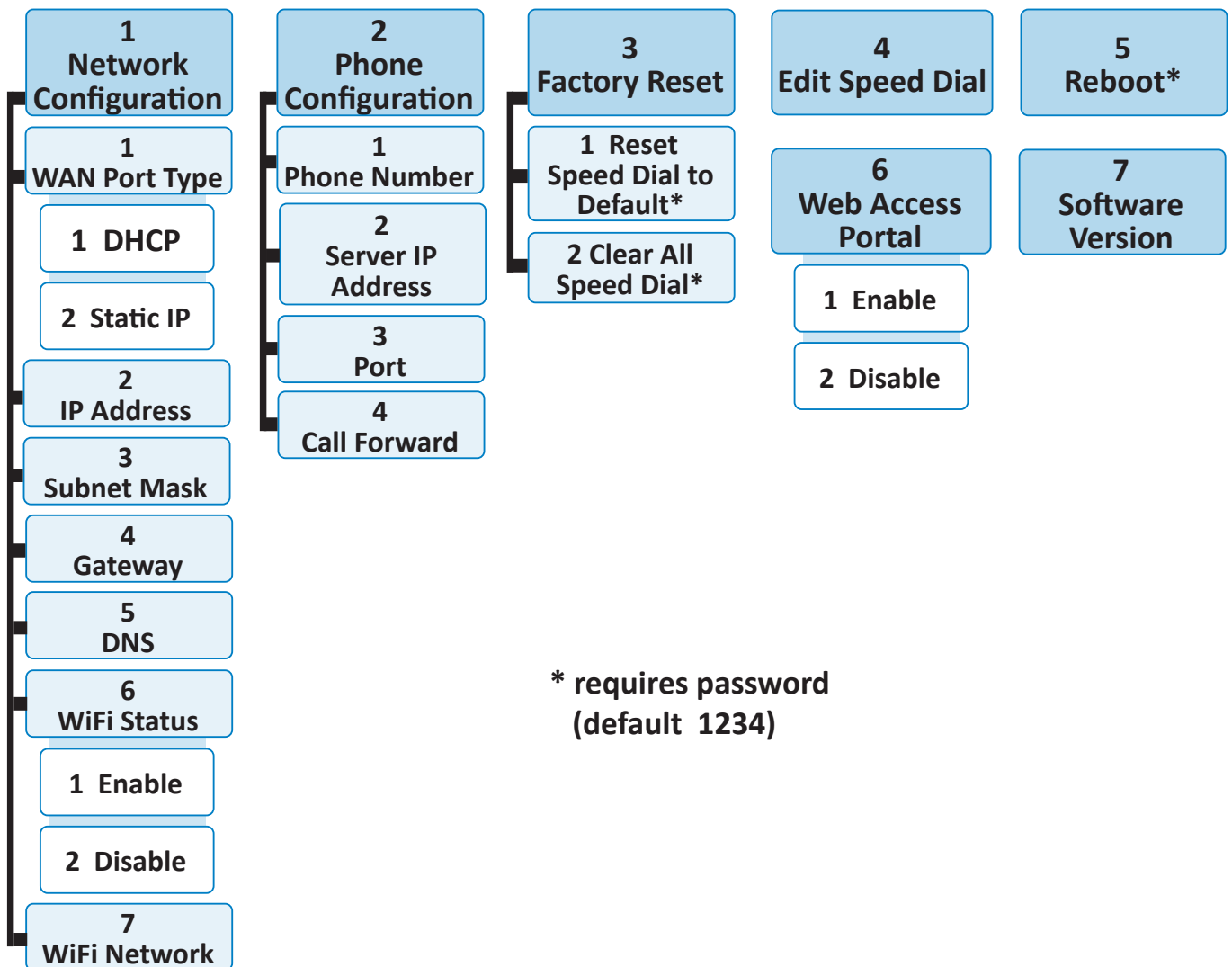

Operation

SIP Cordless 1-line Hotel Telephone - HD101

SIP Cordless 1-line Wi-Fi Enabled Hotel Telephone - HD101W

SIP Cordless 1-line Handset - HD1 Handset

USING THE CORDLESS HANDSET AND THE TELEPHONE BASE

The cordless handset and the telephone base cannot be used on the same call. However, calls can be switched between the cordless handset and the telephone base speakerphone.

When the cordless handset or the telephone base is in use, the **FLASH/TALK** key on the cordless handset and the **MESSAGE WAITING** LED on the telephone base illuminate.

RECEIVE A CALL

When there is an incoming call, the telephone rings and the **MESSAGE WAITING** LED flashes.

ANSWER A CALL USING THE CORDLESS HANDSET WHILE IT IS NOT ON THE TELEPHONE BASE OR CHARGING STAND

On the cordless handset, press **FLASH/TALK** or **◀/SPEAKER**.

- The **FLASH/TALK** key illuminates when in use. The **◀/SPEAKER** key illuminates when in speakerphone mode.

ANSWER A CALL USING THE CORDLESS HANDSET WHILE IT IS CRADLED ON THE TELEPHONE BASE OR CHARGING STAND

Lift the cordless handset from the telephone base or charging stand.

- The **FLASH/TALK** key illuminates when in use. The **◀/SPEAKER** key illuminates when in speakerphone mode.

ANSWER A CALL USING THE TELEPHONE BASE

On the telephone base, press **◀/SPEAKER**.

- The **MESSAGE WAITING** LED and the **◀/SPEAKER** key illuminate when in use.

PLACE A CALL

PLACE A CALL USING THE CORDLESS HANDSET

On the cordless handset, press **FLASH/TALK** or **◀/SPEAKER**. Listen for a dial tone and then dial the desired number, or press a Speed Dial key on the cordless handset to dial a programmed number.

- The **FLASH/TALK** key illuminates when in use. The **◀/SPEAKER** key illuminates when in speakerphone mode.

PLACE A CALL USING THE TELEPHONE BASE

On the telephone base, press **◀/SPEAKER**. Listen for a dial tone and then dial the desired number, or press a Speed Dial key on the telephone base to dial a programmed number.

- The **MESSAGE WAITING** LED and the **◀/SPEAKER** key illuminate when in use.

END A CALL

END A CALL WHEN USING THE CORDLESS HANDSET

Press **OFF** on the cordless handset or place it in the telephone base or charging stand. The call ends when all handsets hang up.

END A CALL WHEN USING THE TELEPHONE BASE

Press **◀/SPEAKER**.

SWITCH A CALL BETWEEN THE CORDLESS HANDSET AND THE TELEPHONE BASE SPEAKERPHONE

- To switch a call from the cordless handset to the telephone base speakerphone, press **◀/SPEAKER** on the telephone base.

- To switch a call from the telephone base speakerphone to the cordless handset which is not on the telephone base cradle, press **FLASH/TALK** or **📞/SPEAKER** on the cordless handset.
- To switch a call from the telephone base speakerphone to the cordless handset which is cradled on the telephone base, lift the cordless handset from the telephone base.

SHARE A CALL

A maximum of two cordless handsets can be used at the same time on an external call.

JOIN A CALL

During a call, press **FLASH/TALK** or **📞/SPEAKER** on another cordless handset to join.

HANDSET SPEAKERPHONE

During a call, press **📞/SPEAKER** on the cordless handset to switch between speakerphone mode and handset earpiece mode.

VOLUME

Listening volume can be adjusted on the cordless handset and the telephone base.

ADJUST THE LISTENING VOLUME

- During a call on the handset, press **-VOLUME+** on it to adjust the listening volume. The next call returns to the default listening volume.
- During a call on the telephone base, press **VOL+** and **VOL-** to adjust the listening volume. The next call returns to the default listening volume.

ADJUST THE RINGER VOLUME OF THE TELEPHONE BASE

Ringer volume of the telephone base can be adjusted. When the telephone base is idle, press **VOL+** and **VOL-** to adjust the ringer volume.

CALL WAITING

1. When you hear a call waiting tone during a call, press **FLASH/TALK** on the cordless handset to put the current call on hold and take the new incoming call.
2. Press **FLASH/TALK** at any time to switch back and forth between calls.

MUTE

MUTE THE MICROPHONE

1. During a call, press **🔇/MUTE** on the cordless handset.
 - The **🔇/MUTE** key illuminates when the mute function is turned on. You can hear the party on the other end but they cannot hear you.
2. Press **🔇/MUTE** again to resume the conversation.
 - The light on the **🔇/MUTE** key turns off.

MESSAGE WAITING INDICATOR

When a voice message is received, the **MESSAGE WAITING** LED on the telephone base flashes.

PLAY MESSAGES

Press **📧/MESSAGES** in idle mode to play messages.

HOLD

TO PLACE A CALL ON HOLD:

During a call, press the **HOLD** key at the cordless handset.

Appendix

Troubleshooting

If you have difficulty with the telephones, please try the suggestions below.

In case of malfunction, contact authorized service personnel, your seller, or Snom.

FOR CORDLESS TELEPHONE

QUESTION	SUGGESTIONS
1. The telephone does not work at all.	<ul style="list-style-type: none">• Make sure the Cat-5 network cable is plugged into the LAN port of the telephone base and the network wall jack with Power over Ethernet (PoE).• Make sure the battery is installed and charged correctly. For optimum daily performance, return the cordless handset to the telephone base, charging base or charging stand after use.• Unplug the Cat-5 network cable from the network wall jack. Wait for approximately 15 seconds, then plug it back in.• Charge the battery in the cordless handset for up to 16 hours.• If the battery is completely depleted, charge the battery for at least 30 minutes before use.• Remove the battery and then install it again. If that still does not work, it may be necessary to purchase a new battery.• Disconnect the telephone base from the network wall jack and connect a different working SIP telephone. If the other SIP telephone does not work, the problem is probably in the wiring or network server. Check your SIP server settings. Refer to the SIP Phone Configuration Guide for details.• Make sure the energy-saving charging mode is not activated. If this mode is activated, all telephone functions will be disabled, except battery charging.

2. There is no dial tone.

- Try all the above suggestions.
- The Cat-5 network cable may be defective. Install a new Cat-5 network cable.
- Make sure your network is providing Power over Ethernet (PoE).
- Disconnect the telephone base from the network wall jack and connect a different working SIP telephone. If there is no dial tone on this telephone either, the problem is in your wiring or network server. Check your SIP server settings and refer to the **SIP Phone Configuration Guide** for details.
- Make sure the initialization and system registration process completes. The speakerphone key blinks twice every second if there are errors with the initialization and system registration process. Check your SIP server settings. Refer to the **SIP Phone Configuration Guide** for details.
- Make sure the energy-saving charging mode is not activated. If this mode is activated, all telephone functions will be disabled, except battery charging.

3. I cannot dial out.

- Try all the above suggestions.
 - Make sure there is a dial tone before dialing. It is normal if the cordless handset takes a second or two to synchronize with the telephone base before producing a dial tone. Wait an extra second before dialing.
 - A prefix may be required for dialing some internal or external calls. Refer to the **SIP Phone Configuration Guide** for details.
 - Check your SIP server settings. If other SIP telephones in your hotel are having the same problem, the problem is in the wiring or network server. Contact your telephone service provider (charges may apply).
-

QUESTION	SUGGESTIONS
4. The Speed Dial key does not work at all.	<ul style="list-style-type: none"> The Speed Dial key may not be properly programmed. Refer to the SIP Phone Configuration Guide for details.
5. The telephone cannot register to the SIP network server.	<ul style="list-style-type: none"> Make sure your network is providing Power over Ethernet (PoE). Make sure the initialization and system registration process completes. If there is an error during the initialization and system registration process, the ▶/SPEAKER key flashes twice every second. Disconnect the Cat-5 network cable from the network wall jack and connect it back into the network wall jack with Power over Ethernet (PoE) to start the initialization and system registration process again.
6. The LOW BATTERY LED illuminates on the cordless handset.	<ul style="list-style-type: none"> Place the cordless handset in the telephone base or charging base for recharging. Remove the battery and then install it again, and use it until fully depleted. Then charge the cordless handset in the telephone base or charging base for up to 16 hours. If the above measures do not correct the problem, replace the battery.
7. The battery does not charge in the cordless handset or the battery does not accept charge.	<ul style="list-style-type: none"> Make sure the cordless handset is placed in the telephone base or charging base correctly. The CHARGE LED should be on. Remove the battery and then install it again. Charge it for up to 16 hours. If the cordless handset is in the telephone base or charging base but the CHARGE LED is not on, refer to The CHARGE LED is off below. If the battery is completely depleted, charge the cordless handset for at least 30 minutes before use. If the above measures do not correct the problem, replace the battery.

QUESTION	SUGGESTIONS
<p>8. The CHARGE LED is off.</p>	<ul style="list-style-type: none"> • Clean the charging contacts on the cordless handset, telephone base, charging base and/or charging stand each month with a pencil eraser or a dry non-abrasive fabric. • Make sure the Cat-5 network cable is plugged in correctly and securely. • Unplug the Cat-5 network cable. Wait for 15 seconds before plugging it back in.
<p>9. The telephone does not ring when there is an incoming call.</p>	<ul style="list-style-type: none"> • Make sure the Cat-5 network cable is plugged into the LAN port of the telephone base and the network wall jack with Power over Ethernet (PoE). • The cordless handset may be too far from the telephone base. Move it closer to the telephone base. • Check your SIP server or telephone administrative settings. Refer to the SIP Phone Configuration Guide for details. • If other SIP telephones in your hotel are having the same problem, the problem is in the wiring or network server. Contact your telephone service provider (charges may apply). • Other electronic products such as HAM radios and other DECT phones can cause interference with your cordless phone. Try installing your phone as far away as possible from these types of electronic devices. • The Cat-5 network cable may be defective. Install a new Cat-5 network cable. • Remove the battery and then install it again. Then place the cordless handset in the telephone base. Wait for the handset to synchronize with the telephone base. Allow up to one minute for this to take place.

10. The cordless handset beeps and is not performing normally.

- Make sure the Cat-5 network cable is plugged into the **LAN** port of the telephone base and the network wall jack with Power over Ethernet (PoE).
- Check your SIP server or telephone administrative settings. Refer to the **SIP Phone Configuration Guide** for details.
- Disconnect the telephone base from the network wall jack and connect a different working SIP telephone. If the other SIP telephone has the same problem, the problem is in the wiring or network server. Contact your telephone service provider (charges may apply).
- Other electronic products such as HAM radios and other DECT phones can cause interference with your cordless phone. Try installing your phone as far away as possible from these types of electronic devices.

11. There is interference during a telephone conversation, or the call fades in and out when I am using the cordless handset.

- The cordless handset may be out of range. Move the handset closer to the telephone base or adjust the setting of RF transmission power. Refer **SIP Phone Configuration Guide** for details.
- Other electronic products such as HAM radios and other DECT phones can cause interference with your cordless phone. Try installing your phone as far away as possible from these types of electronic devices.
- If other SIP telephones in your hotel are having the same problem, the problem is in the wiring or network server. Contact your telephone service provider (charges may apply).

12. I hear other calls when using the telephone.

- Disconnect the telephone base from the network wall jack and connect a different working SIP telephone. Check your SIP server settings. If calls are still not clear, the problem is probably in the wiring or network server. Contact your telephone service provider (charges may apply).

QUESTION	SUGGESTIONS
13. I hear noise on the cordless handset and the keys do not work.	<ul style="list-style-type: none">• Make sure the Cat-5 network cable is plugged in correctly and securely.• Unplug the Cat-5 network cable. Wait for 15 seconds before plugging it back in.
14. Common cure for electronic equipment.	<ul style="list-style-type: none">• If the telephone is not responding normally, put the cordless handset in the telephone base. If it does not fix the problem, try the following (in the order listed):<ol style="list-style-type: none">A. Disconnect the power to the telephone base.B. Disconnect the battery on the cordless handset.C. Wait a few minutes before connecting power to the telephone base.D. Install the battery again and then place the cordless handset in the telephone base.E. Wait for the cordless handset to synchronize with the telephone base. Allow up to one minute for this to take place.

Maintenance

TAKING CARE OF YOUR TELEPHONE

Your telephone contains sophisticated electronic parts, so it must be treated with care.

AVOID ROUGH TREATMENT

Place the handset down gently. Save the original packing materials to protect your telephone if you ever need to ship it.

AVOID WATER

Your telephone can be damaged if it gets wet. Do not use the handset outdoors in the rain, or handle it with wet hands. Do not install the telephone base near a sink, bathtub or shower.

ELECTRICAL STORMS

Electrical storms can sometimes cause power surges harmful to electronic equipment. For your own safety, take caution when using electrical appliances during storms.

CLEANING YOUR TELEPHONE

Your telephone has a durable plastic casing that should retain its luster for many years. Clean it only with a soft cloth slightly dampened with water or mild soap. Do not use excess water or cleaning solvents of any kind.

Remember that electrical appliances can cause serious injury if used when you are wet or standing in the water. If the telephone base should fall into the water, **DO NOT RETRIEVE IT UNTIL YOU UNPLUG THE NETWORK CABLE FROM THE WALL.** Then remove the telephone by the unplugged cords.

Disclaimer and Limitation of Liability

Snom Technology GmbH and its suppliers assume no responsibility for any damage or loss resulting from the use of this user's manual. Snom Technology GmbH and its suppliers assume no responsibility for any loss or claims by third parties that may arise through the use of this product. Snom Technology GmbH and its suppliers assume no responsibility for any damage or loss caused by deletion of data as a result of malfunction, or repairs. Be sure to make backup copies of important data on other media to protect against data loss.

REMEMBER THAT ELECTRICAL APPLIANCES CAN CAUSE SERIOUS INJURY IF USED WHEN YOU ARE WET OR STANDING IN WATER. IF THE TELEPHONE BASE SHOULD FALL INTO WATER, DO NOT RETRIEVE IT UNTIL YOU UNPLUG THE POWER CORD AND/OR ETHERNET CABLE FROM THE WALL. THEN REMOVE THE TELEPHONE BY THE UNPLUGGED CORDS.

European Directives

This equipment is compliant with 2014/53/EU (RED) and 2011/65/EU (ROHS).

Declaration of Conformity

The declaration of conformity can be downloaded at www.snom.com/conformity.



Disposal of batteries and product

These symbols (①, ②) on the products, packaging, and/or accompanying documents mean that used electrical and electronic products and batteries must not be mixed with general household waste.

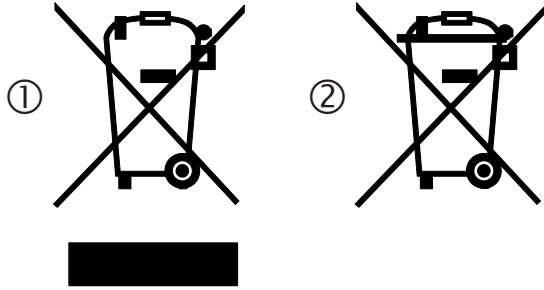

For proper treatment, recovery and recycling of old products and batteries, please take them to applicable collection points in accordance with your national legislation.

By disposing of them correctly, you will help to save valuable resources and prevent any potential negative effects on human health and the environment.

For more information about collection and recycling, please contact your local municipality. Penalties may be applicable for incorrect disposal of this waste, in accordance with national legislation.

PRODUCT DISPOSAL INSTRUCTIONS FOR BUSINESS USERS

If you wish to discard electrical and electronic equipment, please contact your dealer or supplier for further information.

INFORMATION ON DISPOSAL IN OTHER COUNTRIES OUTSIDE THE EUROPEAN UNION

These symbols (①, ②) are only valid in the European Union. If you wish to discard these items, please contact your local authorities or dealer and ask for the correct method of disposal.

NOTE FOR THE BATTERY SYMBOL

This symbol (②) might be used in combination with a chemical symbol. In this case it complies with the requirement set by the Directive for the chemical involved.



snom

Specifications are subject to change without notice.
Copyright © 2023
Snom Technology GmbH
All rights reserved. 11/23.
HD101_HD101W_HD1_UM_V1_CEC_EU-UK_14NOV2023